

Specification

Nominal Voltage	2V	
Nominal Capacity(10hrs rate)	350.0AH	
Dimension	Length	170±2mm(6.69 inches)
	Width	150±2mm(4.33 inches)
	Container Height	328±2mm(12.91 inches)
	Total Height (with Terminal)	350±2mm(13.78 inches)
Approx Weight	Approx 22.0Kg (48.5lbs)	
Design Float Life	20 years at 25°C(77°F)	
Container Material	ABS	
Rated Capacity	374.5AH/18.7A	(20hr, 1.80V/cell, 25°C/77°F)
	350.0AH/35.0A	(10hr, 1.80V/cell, 25°C/77°F)
	304.5AH/60.9A	(5hr, 1.75V/cell, 25°C/77°F)
	273.0AH/91.0A	(3hr, 1.75V/cell, 25°C/77°F)
	217.0AH/217.0A	(1hr, 1.60V/cell, 25°C/77°F)
Max. Discharge Current	2800A (5s)	
Internal Resistance	Approx 0.8mΩ	
Operating Temp. Range	Discharge :	-15~50°C (5~120°F)
	Charge :	0~40°C (5~104°F)
	Storage :	-15~40°C (5~104°F)
Nominal Operating Temp. Range	25 ± 3°C (77 ± 5°F)	
Cycle Use	Initial Charging Current less than 105.0A. Voltage	
	2.4V~2.5V at 25°C(77°F)Temp. Coefficient -5mV/°C	
Standby Use	No limit on Initial Charging Current Voltage	
	2.25V~2.3V at 25°C(77°F)Temp. Coefficient -3mV/°C	
Capacity affected by Temperature	40°C (104°F)	103%
	25°C (77°F)	100%
	0°C (32°F)	86%
Self Discharge	≤1.5% per month	
	RUZET TPA series batteries may be stored for up to 6 months at 25°C(77°F) and then a freshening charge is required.	

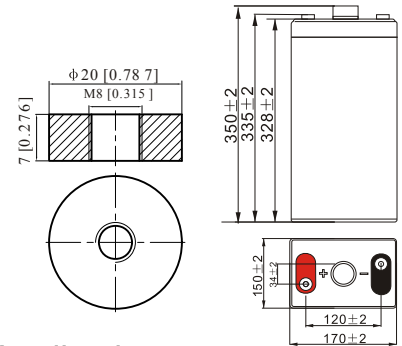

Applications

- UPS and EPS
- Emergency light
- Railway signal and aircraft signal system
- Marine and power stations Alarm and security system
- Electronic apparatus and equipment
- Communication power supply, DC power supply

Constant Current Discharge (Amperes) at 25°C (77°F)

F.V/Time	10 min	15 min	20 min	30 min	45 min	1h	2h	3h	4h	5h	6h	8h	10h	20h
1.85V/cell	409.5	344.4	305.6	253.4	195.5	167.3	108.3	81.4	66.7	56.1	49.2	39.5	33.9	18.1
1.80V/cell	468.6	386.7	337.8	275.2	210.9	176.6	116.4	87.5	70.9	59.5	52.1	41.5	35.0	18.7
1.75V/cell	532.2	435.9	373.3	299.1	230.1	192.5	121.1	91.0	73.4	60.9	53.7	42.9	35.9	19.2
1.70V/cell	601.0	483.6	412.1	326.5	247.8	203.7	127.6	95.8	76.7	64.4	56.3	44.7	37.3	19.7
1.65V/cell	645.5	517.8	438.4	344.6	262.3	210.7	132.3	99.6	79.7	66.4	58.3	46.2	38.4	20.3
1.60V/cell	710.1	567.1	476.2	367.7	272.5	217.0	135.6	102.2	81.4	68.0	59.5	47.0	39.2	20.6

Constant Power Discharge (Watts) at 25°C (77°F)

F.V/Time	10 min	15 min	20 min	30 min	45 min	1h	2h	3h	4h	5h	6h	8h	10h	20h
1.85V/cell	764.6	649.5	582.1	488.0	379.8	326.1	212.5	160.4	131.8	111.2	97.7	78.7	67.8	36.2
1.80V/cell	864.7	719.7	634.2	522.1	406.5	342.3	227.0	171.3	139.3	117.3	103.1	82.6	69.9	37.4
1.75V/cell	966.6	801.3	694.2	562.7	439.2	371.5	235.2	177.5	143.7	119.6	106.0	85.1	71.6	38.3
1.70V/cell	1067.2	876.7	760.6	610.9	471.3	391.9	247.2	186.5	149.8	126.3	110.9	88.6	74.3	39.3
1.65V/cell	1135.6	931.6	803.1	639.5	494.4	402.4	254.8	193.2	155.1	129.9	114.4	91.4	76.3	40.4
1.60V/cell	1221.2	1003.6	863.1	677.7	511.0	412.3	260.0	197.2	158.1	132.6	116.4	92.8	77.8	41.0