

## Specification

Nominal Voltage	2V	
Nominal Capacity(10hrs rate)	350.0AH	
Dimension	Length	170 ± 2mm(6.69 inches)
	Width	150 ± 2mm(4.33 inches)
	Container Height	328 ± 2mm(12.91 inches)
	Total Height (with Terminal)	350 ± 2mm(13.78 inches)
Approx Weight	Approx 22.0Kg (48.5lbs)	
Design Float Life	20 years at 25°C(77°F)	
Container Material	ABS	
Rated Capacity	374.5AH/18.7A	(20hr, 1.80V/cell, 25°C/77°F)
	350.0AH/35.0A	(10hr, 1.80V/cell, 25°C/77°F)
	304.5AH/60.9A	( 5hr, 1.75V/cell, 25°C/77°F)
	273.0AH/91.0A	( 3hr, 1.75V/cell, 25°C/77°F)
	217.0AH/217.0A	( 1hr, 1.60V/cell, 25°C/77°F)
Max. Discharge Current	2800A (5s)	
Internal Resistance	Approx 0.8mΩ	
Operating Temp. Range	Discharge :	-15~50°C (5~120°F)
	Charge :	0~40°C (5~104°F)
	Storage :	-15~40°C (5~104°F)
Nominal Operating Temp. Range	25 ± 3°C (77 ± 5°F)	
Cycle Use	Initial Charging Current less than 105.0A. Voltage	
	2.4V~2.5V at 25°C(77°F)Temp. Coefficient -5mV/°C	
Standby Use	No limit on Initial Charging Current Voltage	
	2.25V~2.3V at 25°C(77°F)Temp. Coefficient -3mV/°C	
Capacity affected by Temperature	40°C (104°F)	103%
	25°C ( 77°F)	100%
	0°C ( 32°F)	86%
Self Discharge	≤1.5% per month	
	RUZET TPA series batteries may be stored for up to 6 months at 25°C(77°F) and then a freshening charge is required.	

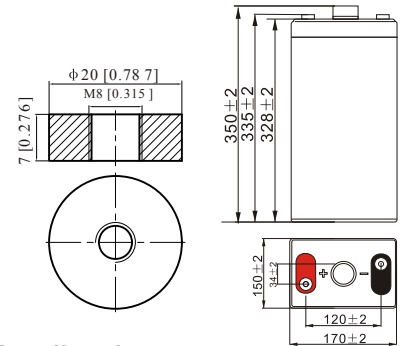

## Applications

- UPS and EPS
- Emergency light
- Railway signal and aircraft signal system
- Marine and power stations Alarm and security system
- Electronic apparatus and equipment
- Communication power supply, DC power supply

### Constant Current Discharge (Amperes) at 25°C (77°F)

F.V/Time	10 min	15 min	20 min	30 min	45 min	1h	2h	3h	4h	5h	6h	8h	10h	20h
1.85V/cell	409.5	344.4	305.6	253.4	195.5	167.3	108.3	81.4	66.7	56.1	49.2	39.5	33.9	18.1
1.80V/cell	468.6	386.7	337.8	275.2	210.9	176.6	116.4	87.5	70.9	59.5	52.1	41.5	35.0	18.7
1.75V/cell	532.2	435.9	373.3	299.1	230.1	192.5	121.1	91.0	73.4	60.9	53.7	42.9	35.9	19.2
1.70V/cell	601.0	483.6	412.1	326.5	247.8	203.7	127.6	95.8	76.7	64.4	56.3	44.7	37.3	19.7
1.65V/cell	645.5	517.8	438.4	344.6	262.3	210.7	132.3	99.6	79.7	66.4	58.3	46.2	38.4	20.3
1.60V/cell	710.1	567.1	476.2	367.7	272.5	217.0	135.6	102.2	81.4	68.0	59.5	47.0	39.2	20.6

### Constant Power Discharge (Watts) at 25°C (77°F)

F.V/Time	10 min	15 min	20 min	30 min	45 min	1h	2h	3h	4h	5h	6h	8h	10h	20h
1.85V/cell	728.19	618.57	554.38	464.76	361.71	310.57	202.38	152.76	125.52	105.90	93.05	74.95	64.57	34.48
1.80V/cell	823.52	685.43	604.00	497.24	387.14	326.00	216.19	163.14	132.67	111.71	98.19	78.67	66.57	35.62
1.75V/cell	920.57	763.14	661.14	535.90	418.29	353.81	224.00	169.05	136.86	113.90	100.95	81.05	68.19	36.48
1.70V/cell	1016.38	834.95	724.38	581.81	448.86	373.24	235.43	177.62	142.67	120.29	105.62	84.38	70.76	37.43
1.65V/cell	1081.52	887.24	764.86	609.05	470.86	383.24	242.67	184.00	147.71	123.71	108.95	87.05	72.67	38.48
1.60V/cell	1163.05	955.81	822.00	645.43	486.67	392.67	247.62	187.81	150.57	126.29	110.86	88.38	74.10	39.05